

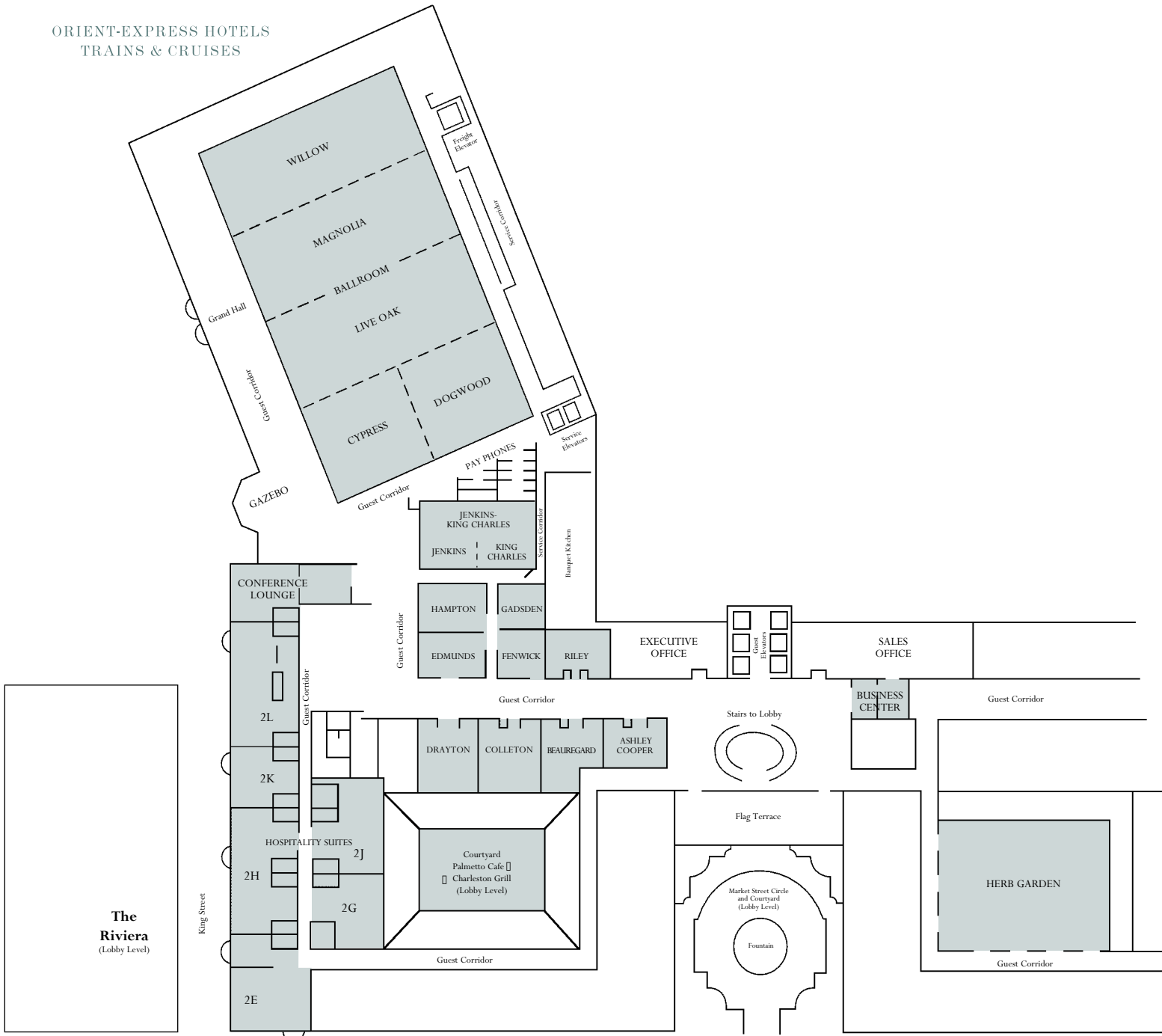

Charleston Place Hotel

Function Space Diagram

ORIENT-EXPRESS HOTELS
TRAINS & CRUISES



GRAND BALLROOM



THE RILEY BOARDROOM



GRAND BALLROOM



GRAND HALL-PREFUNCTION AREA

banquet room/meeting room capacities

we offer the ultimate in flexible meeting space, with more than 30,000 square feet within the hotel, including the Grand Ballroom (14,000+ square feet), ten more function rooms, eight hospitality suites, the Grand Hall, and several outdoor courtyards.

	Floor #	Square Footage	Dimensions	Ceiling Height	Floor Covering	Portable Walls	Theater	Schoolroom	Banquet	Reception	Hollow Square	8'x10'	Exhibits 10'x10' U-Shaped	
BALLROOM	2	14,432	164' x 88'	16'	Carpet	Yes	1,450	860	1,120	1,700	-	90	70	
Cypress	2	1,804	41' x 44'	16'	Carpet	Yes	150	96	120	200	50	10	8	40
Dogwood	2	1,804	41' x 44'	16'	Carpet	Yes	150	96	120	200	50	10	8	40
Live Oak	2	3,608	41' x 88'	16'	Carpet	Yes	350	216	250	250	88	22	15	80
Magnolia	2	3,608	41' x 88'	16'	Carpet	Yes	350	216	250	250	88	22	15	80
Willow	2	3,608	41' x 88'	16'	Carpet	Yes	350	216	250	250	88	22	15	80
Grand Hall	2	4,100	164' x 25'	16'	Carpet	No	-	-	-	-	350	-	20	15
Gazebo	2	500	Oval	16'	Marble	No	-	-	-	-	75	-	-	-
MEETING ROOMS														
Jenkins-King Charles	2	1,296	27' x 48'	10'	Carpet	Yes	100	72	80	100	40	-	-	40
Jenkins	2	648	27' x 24'	10'	Carpet	Yes	40	32	40	40	22	-	-	14
King Charles	2	648	27' x 24'	10'	Carpet	Yes	40	32	40	40	22	-	-	14
Colleton	2	780	26' x 30'	10'	Carpet	No	70	36	50	65	30	-	-	24
Drayton	2	750	25' x 30'	10'	Carpet	No	70	36	50	65	30	-	-	24
Beauregard	2	720	25' x 30'	10'	Carpet	No	30	30	40	40	20	-	-	18
Ashley Cooper	2	560	20' x 28'	10'	Carpet	No	30	27	30	30	20	-	-	18
Hampton	2	560	20' x 28'	10'	Carpet	No	36	24	30	30	20	-	-	18
Edmunds	2	532	19' x 28'	10'	Carpet	No	24	24	30	30	18	-	-	15
Gadsden	2	399	19' x 21'	10'	Carpet	No	21	15	30	20	15	-	-	12
Fenwick	2	380	19' x 20'	10'	Carpet	No	36	12	20	20	15	-	-	12
Riley	2	532	19' x 28'	10'	Carpet	No	-	-	-	-	-	-	-	-
HOSPITALITY SUITES														
2E	2	1,420		10'	Carpet	No	-	N/A	-	75	-	-	-	-
2G	2	930	30' x 19'	10'	Carpet	No	-	-	-	30	-	-	-	-
2H	2	1,423	40' x 19'	10'	Carpet	No	75	54	-	75-100	33	-	-	30
2J	2	1,423	40' x 19'	10'	Carpet	No	60	30	-	75	28	-	-	25
2K	2	795	27' x 19'	10'	Carpet	No	30	15	-	30	18	-	-	15
2L	2	1,423	40' x 19'	10'	Carpet	No	75	54	-	75-100	33	-	-	30
Herb Garden	2	3,795	55' x 69'		-	-	-	-	-	200	-	-	-	-
Flag Terrace	-	-	-	-	-	-	-	-	50	75	-	-	-	-
Conference Lounge	-	-	-	-	-	-	-	-	-	-	-	-	-	-
Market Street Circle	-	-	-	-	-	-	-	-	-	-	-	-	-	-
RIVIERA														
Conference Theatre	-	-	-	Varies	Carpet	Yes	289	-	-	-	-	-	-	-
Rooftop Terrace	-	1,166	53' x 22'	-	Tile	No	-	-	48	75	-	-	-	-
Sottile Ballroom	-	4,032	84' x 48'	20'	Carpet	Yes	450	250	336	550	90	24	18	75
Academy Room	-	1,300	40' x 33'	12'	Carpet	No	100	72	80	100	40	-	-	34
Screening Room	-	651	21' x 31'	12'	Carpet	No	50	30	48	50	30	-	-	24

Meeting room capacities were determined by use of the "Arranger & Comfort Calculator" by Meeting Professionals International.

Note: Our two dining rooms can serve as additional banquet space. Palmetto Café and the courtyard can accommodate evening functions for up to 200 people. Charleston Grill is available for breakfast or lunch functions for up to 150 people.